



## SBS6028 SERIES –Shielded SMD Power Inductors



RoHS Compliant

### PART NUMBERING SYSTEM

<b>SBS</b>	<b>6 0 2 8</b>	-	<b>1 0 0 M</b>	-	<b>LF</b>
TYPE	DIMENSIONS		INDUCTANCE		LEAD FREE

### SHAPES AND DIMENSIONS

UNIT : mm

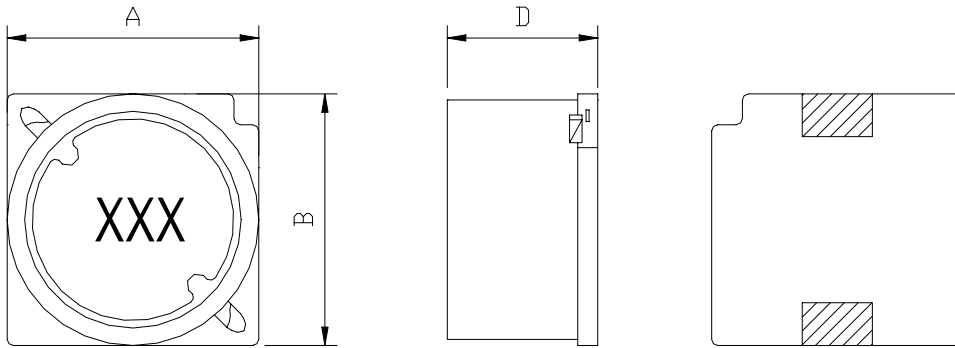

**A=6.2 Max. B=6.2 Max. D=3.0 Max.**

### RECOMMENDED PATTERNS

UNIT : mm

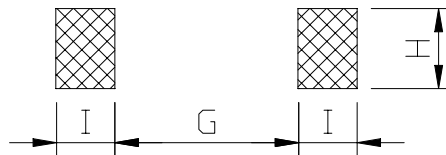

**G=4.0 H=2.2 I=1.5**

## SBS6028 SERIES –Shielded SMD Power Inductors



RoHS Compliant

### SPECIFICATION TABLE

PART NUMBER	INDUCTANCE ( $\mu$ H)	DCR ( $\Omega$ ) (Max.)	Isat (A) ( Max. )	Irms (A) ( Max. )	TEST FREQ. ( f )
SBS6028-4R7M-LF	4.7 $\pm$ 20%	0.0340	1.6	2.5	100KHz
SBS6028-6R8M-LF	6.8 $\pm$ 20%	0.0424	1.5	2.2	100KHz
SBS6028-100M-LF	10 $\pm$ 20%	0.0638	1.3	1.8	100KHz
SBS6028-150M-LF	15 $\pm$ 20%	0.0894	1.0	1.4	100KHz
SBS6028-220M-LF	22 $\pm$ 20%	0.124	0.77	1.3	100KHz
SBS6028-330M-LF	33 $\pm$ 20%	0.177	0.69	1.0	100KHz
SBS6028-470M-LF	47 $\pm$ 20%	0.252	0.59	0.92	100KHz
SBS6028-680M-LF	68 $\pm$ 20%	0.348	0.50	0.78	100KHz
SBS6028-101M-LF	100 $\pm$ 20%	0.516	0.42	0.64	100KHz

Isat : DC current at which the inductance drops 30% (typ) from its value without current.

Irms: The actual current when temperature of coil becomes 40°C . ( Ta=+25°C )

Operating temperature range -40 to +85 ,

Electrical specifications at 25 .

### PACKAGING SPECIFICATION

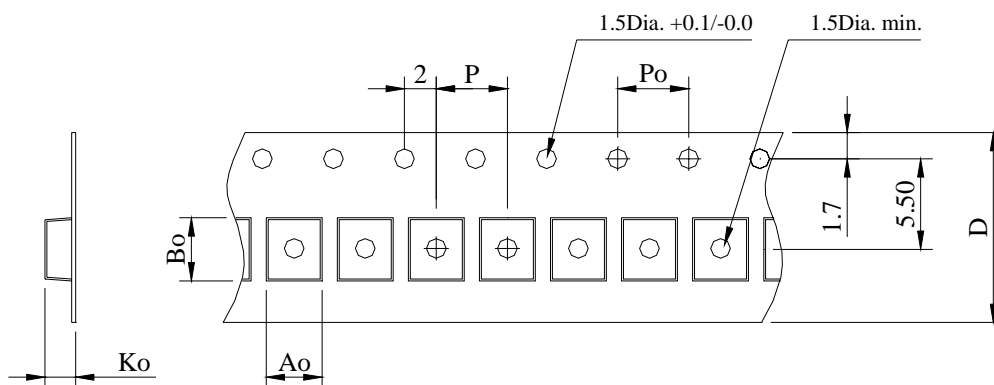

STAYLE	Q ' TY (PCS)	DIMENSIONS (m/m)					D $\pm$ 0.3
		Ao	Bo	Ko	P	Po	
13"	1,000	6.50	6.50	3.50	8.00	4.00	12.0