



SDC2D18LD SERIES - Low Profile SMD Power Inductors



PART NUMBERING SYSTEM

<u>SDC</u>	<u>2 D 1 8 L D</u>	-	<u>2 R 2 N</u>	-	<u>LF</u>
TYPE	DIMENSIONS		INDUCTANCE		LEAD FREE

SHAPES AND DIMENSIONS

UNIT : mm

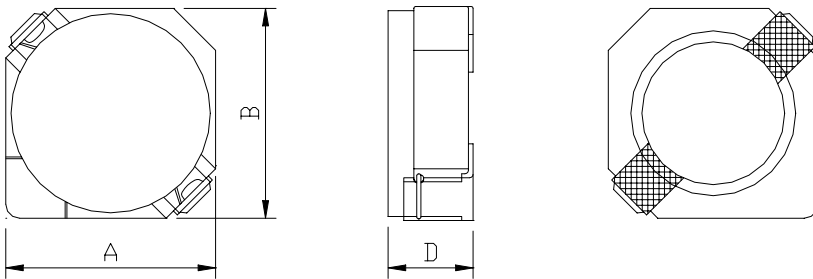

A=3.20 max. B=3.20 max. D=2.0 max.

RECOMMENDED PATTERNS

UNIT : mm

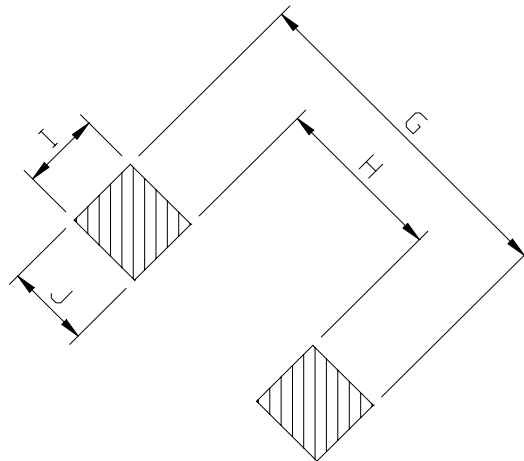

G= 4.3 H= 1.7 I= 1.3 J= 1.3



SDC2D18LD SERIES



RoHS Compliant

ELECTRICAL CHARACTERISTICS :

PART NUMBER	INDUCTANCE (μ H)	DCR (m Ω) (Max.)	Isat (A) (Max.)	Irms (A) (Max.)	TEST FREQ. (f)
SDC2D18LD-2R2N-LF	2.2 \pm 30%	41	0.85	2.30	100KHz
SDC2D18LD-3R3N-LF	3.3 \pm 30%	54	0.75	2.10	100KHz
SDC2D18LD-4R7N-LF	4.7 \pm 30%	78	0.63	1.65	100KHz
SDC2D18LD-6R8N-LF	6.8 \pm 30%	106	0.52	1.32	100KHz
SDC2D18LD-100N-LF	10 \pm 30%	180	0.43	1.00	100KHz
SDC2D18LD-150N-LF	15 \pm 30%	220	0.35	0.80	100KHz
SDC2D18LD-220N-LF	22 \pm 30%	320	0.30	0.68	100KHz
SDC2D18LD-330N-LF	33 \pm 30%	460	0.24	0.56	100KHz
SDC2D18LD-470N-LF	47 \pm 30%	660	0.20	0.48	100KHz

Isat : DC current at which the inductance drops 35% (typ) from its value without current.

Irms: The actual current when temperature of coil becomes 40°C . (Ta=+20°C)

Operating temperature range -40°C to +85°C , Electrical specifications at 20°C.

Packing : 13" reel, machine-ready ,embossed plastic tape (2,000 parts per full reel).