



SDC3D14S SERIES

Low Profile Shielded Power Inductors



RoHS Compliant

PART NUMBERING SYSTEM

| | | | | | |
|------------|--------------|---|----------------|---|-----------|
| SDC | 3D14S | — | 1 R 0 N | — | LF |
| TYPE | DIMENSIONS | | INDUCTANCE | | LEAD FREE |

SHAPES AND DIMENSIONS

UNIT : mm

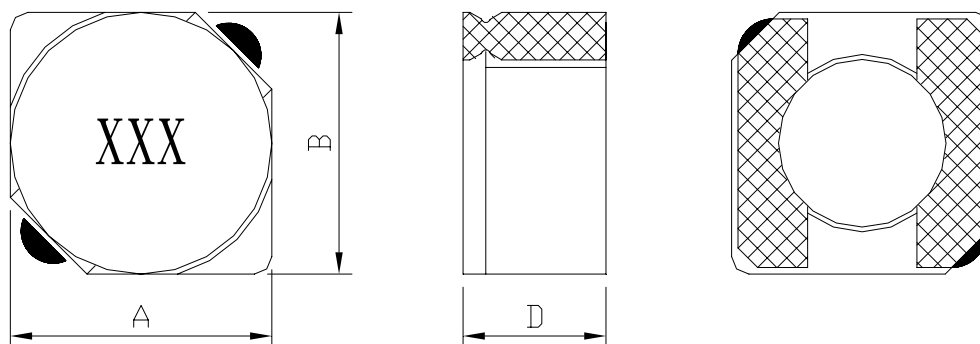

A=4.0 Max. B=4.0 Max. D=1.55 Max.

PCB LAYOUT

UNIT : mm

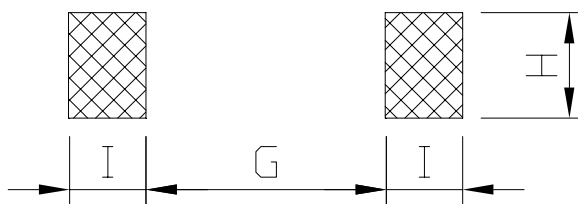

G=1.30 H=3.90 I=1.30

FEATURES

- Only **4.0 mm square** and **1.55 mm high**
- **Magnetically shielded, low profile** power inductor
- Saturation current rating **up to 2.55 Amps**
- Inductance ratings from 1.0 to 1,500 μ H
- **RoHS-compliant.** 260°C compatible. Gold over nickel over phos bronze terminations



SDC3D14S SERIES

Low Profile Shielded Power Inductors



RoHS Compliant

ELECTRICAL CHARACTERISTICS :

| PART NUMBER | INDUCTANCE (μ H) | DCR (m Ω) (max) | Isat (A) (Max.) | Irms (A) (Max.) | TEST FREQ. (f) |
|------------------|--------------------------|----------------------------|----------------------|----------------------|---------------------|
| SDC3D14S-1R0N-LF | 1.0 \pm 30% | 0.045 | 2.55 | 2.10 | 100KHz |
| SDC3D14S-2R2N-LF | 2.2 \pm 30% | 0.100 | 1.50 | 1.60 | 100KHz |
| SDC3D14S-3R3N-LF | 3.3 \pm 30% | 0.145 | 1.30 | 0.35 | 100KHz |
| SDC3D14S-4R7N-LF | 4.7 \pm 30% | 0.175 | 1.30 | 0.25 | 100KHz |
| SDC3D14S-4R7N-LF | 5.6 \pm 30% | 0.220 | 1.20 | 1.10 | 100KHz |
| SDC3D14S-6R8N-LF | 6.8 \pm 30% | 0.240 | 0.86 | 1.10 | 100KHz |
| SDC3D14S-8R2N-LF | 8.2 \pm 30% | 0.270 | 0.78 | 1.00 | 100KHz |
| SDC3D14S-100M-LF | 10 \pm 20% | 0.330 | 0.70 | 0.87 | 100KHz |
| SDC3D14S-150M-LF | 15 \pm 20% | 0.440 | 0.59 | 0.82 | 100KHz |
| SDC3D14S-180M-LF | 18 \pm 20% | 0.575 | 0.71 | 0.68 | 100KHz |
| SDC3D14S-220M-LF | 22 \pm 20% | 0.720 | 0.49 | 0.60 | 100KHz |
| SDC3D14S-330M-LF | 33 \pm 20% | 0.920 | 0.40 | 0.58 | 100KHz |
| SDC3D14S-470M-LF | 47 \pm 20% | 1.40 | 0.34 | 0.47 | 100KHz |
| SDC3D14S-560M-LF | 56 \pm 20% | 1.55 | 0.31 | 0.42 | 100KHz |
| SDC3D14S-680M-LF | 68 \pm 20% | 1.80 | 0.29 | 0.40 | 100KHz |
| SDC3D14S-820M-LF | 82 \pm 20% | 2.00 | 0.26 | 0.39 | 100KHz |
| SDC3D14S-101M-LF | 100 \pm 20% | 2.75 | 0.24 | 0.37 | 100KHz |
| SDC3D14S-121M-LF | 120 \pm 20% | 3.45 | 0.22 | 0.30 | 100KHz |
| SDC3D14S-151M-LF | 150 \pm 20% | 4.10 | 0.20 | 0.27 | 100KHz |
| SDC3D14S-181M-LF | 180 \pm 20% | 4.80 | 0.18 | 0.25 | 100KHz |
| SDC3D14S-221M-LF | 220 \pm 20% | 6.00 | 0.17 | 0.22 | 100KHz |
| SDC3D14S-331M-LF | 330 \pm 20% | 9.30 | 0.13 | 0.18 | 100KHz |
| SDC3D14S-471M-LF | 470 \pm 20% | 12.0 | 0.11 | 0.16 | 100KHz |
| SDC3D14S-561M-LF | 560 \pm 20% | 14.0 | 0.11 | 0.145 | 100KHz |
| SDC3D14S-681M-LF | 680 \pm 20% | 18.5 | 0.105 | 0.125 | 100KHz |
| SDC3D14S-821M-LF | 820 \pm 20% | 24.0 | 0.100 | 0.110 | 100KHz |
| SDC3D14S-102M-LF | 1000 \pm 20% | 31.0 | 0.100 | 0.100 | 100KHz |
| SDC3D14S-152M-LF | 1500 \pm 20% | 44.0 | 0.090 | 0.090 | 100KHz |

- Isat : DC current at which the inductance drops 30% (typ) from its value without current.
- Irms: The actual current when temperature of coil becomes Δ 40°C . (Ta=+20°C)
- Operating temperature range -40°C to +85°C , Electrical specifications at 20°C.
- Packing : 13" reel, machine-ready ,embossed plastic tape (3,500 parts per full reel).