



SEP1004E SERIES - High Current SMD Power Inductors



PART NUMBERING SYSTEM

SEP	1 0 0 4 E	-	1 R 0 M	-	LF
TYPE	DIMENSIONS		INDUCTANCE		LEAD FREE

SHAPES AND DIMENSIONS :



FEATURES :

- * Low profile.
- * Magnetically shielded low DC resistance .
- * Suitable for large current application.
- * Laptop & Notebook computers.
- * Battery powered equipment.
- * DC/DC converters.
- * Digital, Cameras, Scanners, CD-ROM & DVD.

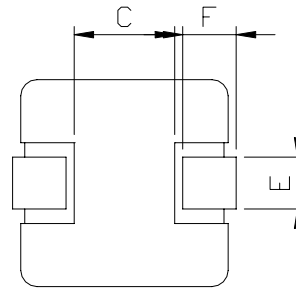
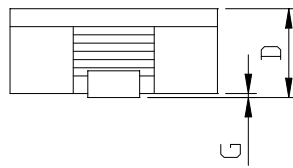
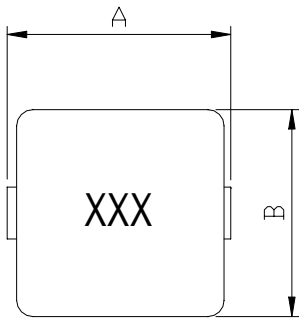

A=11.5±0.5 B=10.5±0.5 C=6.0 Ref. D=4.0 Max. E=2.8±0.3 F=2.0±0.3 G=0.2 Max. UNIT : mm

RECOMMENDED PATTERNS

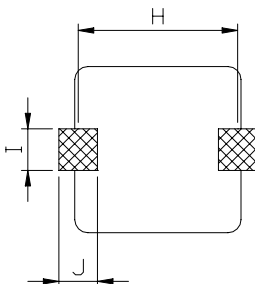

H= 9.50 I= 4.00 J= 3.50 UNIT : mm



SEP1004E SERIES – High Current SMD Power Inductors



RoHS Compliant

SPECIFICATION TABLE

PART NUMBER	INDUCTANCE (μ H)	I _{sat} (A)		I _{rms} (A)		DCR (m Ω) (Max.)
		(Max.)	(t) 40	(Max.)		
SEP1004E-R36M-LF	0.36 \pm 20%	35		35		0.95
SEP1004E-R47M-LF	0.47 \pm 20%	32		32		1.20
SEP1004E-R56M-LF	0.56 \pm 20%	30		30		1.35
SEP1004E-R78M-LF	0.78 \pm 20%	25		25		1.70
SEP1004E-1R0M-LF	1.00 \pm 20%	21		21		2.50
SEP1004E-1R8M-LF	1.80 \pm 20%	15		15		5.00
SEP1004E-2R0M-LF	2.00 \pm 20%	14		14		5.80

Inductance measured at 100 kHz, 0.1 V_{rms}

I_{sat} : DC current at which the inductance drops 20% (typ) from its value without current.

I_{rms} : Average current for a 40°C temperature rise above 25°C ambient.

Operating temperature range -40 to +120 ,

Electrical specifications at 20 .

PACKAGING SPECIFICATION

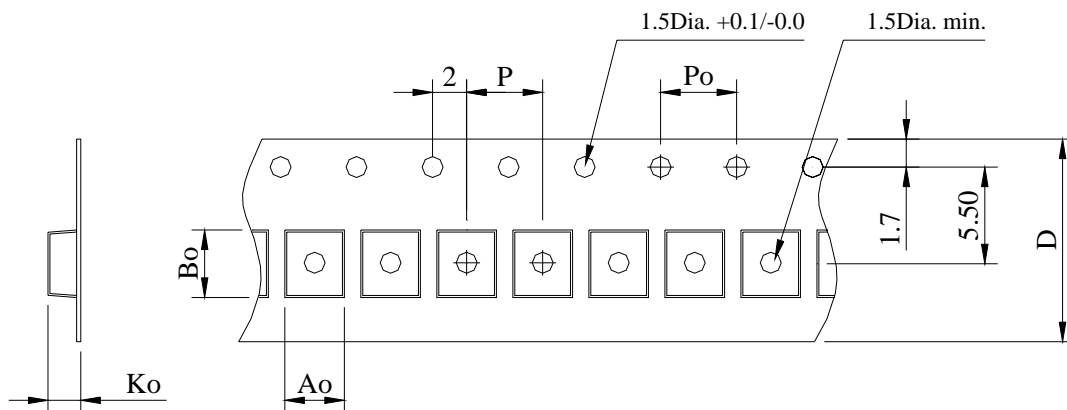

STAYLE	Q ' TY (PCS)	DIMENSIONS (m/m)					
		A_o	B_o	K_o	P	P_o	$D\pm 0.3$
13"	500	12.2	11.2	4.1	16	4.0	24